

- EO 
- AEO 
- RF 
- GNSS 
- RAY 

SE-3D-DB



3D DATABASES

FAST 

SE-3D-DB is a catalog of ready to use 3D mock up dedicated to sensor simulation. Those 3D synthetic environments include physical attributes for infra-red and electromagnetic renderings.

Features

- Fully compatible with the SE-Workbench
- Ready to use for EO and EM rendering
- Compatible with SE-RAY and SE-FAST
- Delivered with independent 3D entities like buildings, vehicles, aircrafts, ships...
- Can be used as template for operational databases



Operational Databases

Desert base1: 3km x 3km



Desert base2: 16km x 16km



Airport base1: 18km x 18km



Airport base2: 120km x 120km



Sea base: 44km x 32km



Rural base: 11km x 8km

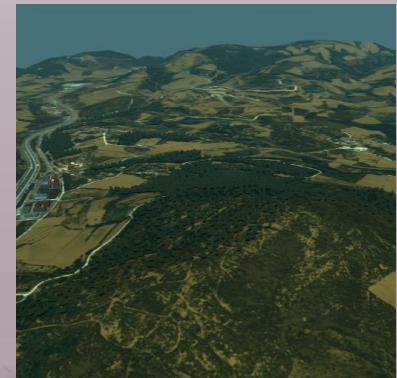

Those databases come with 18 pre-computed atmospheric conditions covering a wide range of situations (winter, summer, rain, fog, ...)

- Urban canyon with 3D building frontages

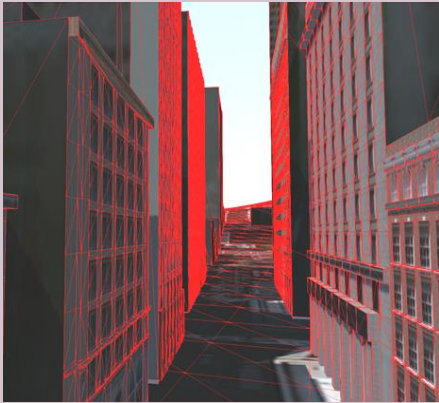

- Geo-typical and geo-specific textures



- Classified for EO and EM

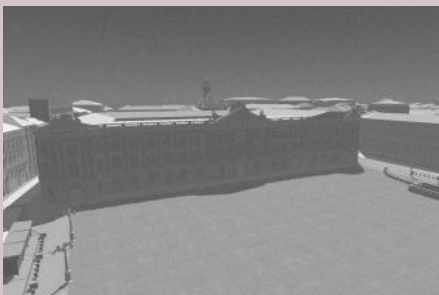

Urban databases

Urban architecture is highly dependent of the country, the economic development, the suburbs, etc... the OKTAL-SE catalog already includes several tens of world cities from US, Europe, Asia and Australia. Those 3D mock up can be easily customized by OKTAL-SE implementing geo-specific models of buildings and urban structures

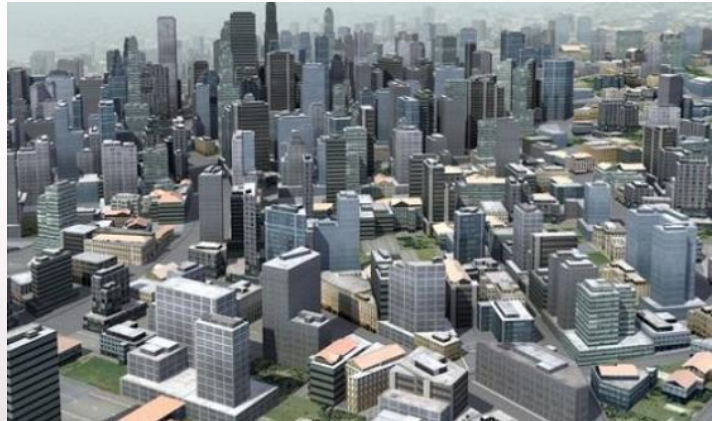

3D urban models on demand

OKTAL-SE provides an efficient way to model any city all over the world in a short lead time. A zone of interest can be selected by the end-user and OKTAL-SE enriches this specific area according to user requirements

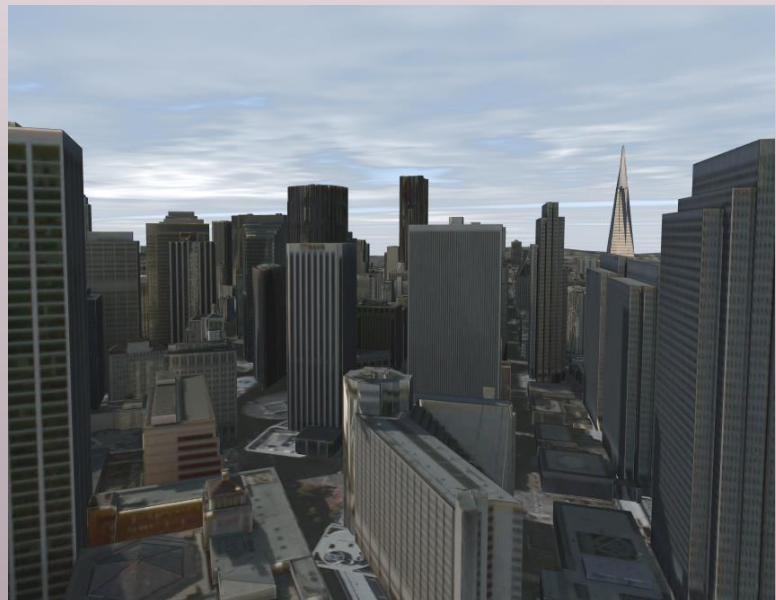

OKTAL-SE

11 avenue du Lac 31320 Vigoulet-Auzil France
Phone: +33 (0)5 67 70 02 00 - Fax: +33 (0)5 67 70 02 05
Mail: contact@oktal-se.fr website: www.oktal-se.com